

## Novisa Builds Sustainable Living Spaces More Efficiently with ZWCAD



**INDUSTRY**

Residential Real Estate Development

**PRODUCTS**

High-quality, eco-friendly residential development in Warsaw, Łódź and surroundings

**WEBSITE**

<https://novisa.pl/>

## ❓ CHALLENGES

- Rising subscription costs with previous CAD software, putting pressure on the budget
- Limited compatibility with essential data formats, complicating collaboration with external partners
- Slow responsiveness with large drawings, causing delays and reducing productivity

## 💡 SOLUTION

ZWCAD

## ✅ RESULTS

- Enhanced design efficiency from initial planning to final documentation with ZWCAD's robust features
- Smoother collaboration with external partners through broad format compatibility, including DWG
- Cost savings and added flexibility through customizable plug-ins, allowing Novisa to allocate resources toward project quality and sustainable growth

Headquartered in Warsaw, Poland, Novisa Development has become a significant player in the real estate industry by creating modern, high-quality residential developments. The company specializes in developing comfortable, functional, and eco-friendly flats and houses, all designed to foster community and offer residents access to nature. Novisa's commitment to sustainability and innovation is at the core of its approach, focusing on creating harmonious living spaces that meet contemporary needs.



Garden City 3 (Miasto Ogród 3), two Novisa residential buildings with 70 flats, including private gardens and terraces

"Novisa's mission is to create harmonious spaces that inspire people to live in harmony with nature and the spirit of sustainable development. We want our residents to feel safe, and comfortable and could build strong ties within the local community" explains Yuliia Saiko, Head of Marketing and PR at Novisa Development, "Our priority is to implement investments in thoroughly selected locations which combine the convenience of everyday life with an appreciation for nature."

## From Challenges to Solutions: Finding the Right Fit with ZWCAD

As Novisa expanded, so did the demands on their design process. The company had been using a CAD software solution that was no longer meeting their needs. With each passing year, subscription costs rose, placing strain on their operational budget, while the software's limited data format compatibility hindered collaboration with partners. Furthermore, the lack of accessible support left Novisa's team without help when technical issues arose, slowing their workflow at crucial stages.

In search of a better solution, Novisa turned to ZWCAD. They needed CAD software that wouldn't just lower expenses but would also offer the flexibility and dependability essential to their work. Now, ZWCAD is "an important tool used in the architectural and technical design process," allowing Novisa's design teams to create "precise construction drawings, development plans, and detailed technical designs for buildings and individual premises."

## Supporting Every Role in the Design Process

At Novisa, every member of the team, from architects to engineers, relies on ZWCAD in different ways, and this diversity of use has become a crucial element of the company's success. Architects use the platform to create and edit building plans, while structural engineers depend on it to design the structural and



technical installations that form the backbone of each project. Tenant change specialists at Novisa effectively develop interior layouts, taking care of every detail and visualizing spaces tailored to the individual needs of residents. Consultants and cost estimators lean on ZWCAD's tools to prepare accurate quotations and estimates, aligning budgets with client expectations.

ZWCAD serves as a valuable resource across these roles, equipping each team member with the tools they need to support Novisa's broader objectives in project development and collaboration.

## Stability and Efficiency in Project Workflows

One of the key benefits Novisa has found with ZWCAD is its high level of stability and performance, especially when working with large, detailed drawings. Given the intricate nature of their residential projects, smooth software operation is crucial to avoid disruptions and maintain productivity. ZWCAD's stability and responsiveness allow the team to work seamlessly, even with files containing extensive architectural layouts, technical specifications, and complex design elements.

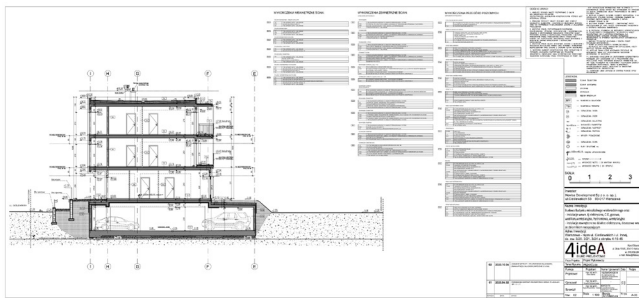

Novisa's residential building cross-section designed in ZWCAD

The team has noted that ZWCAD performs exceptionally well with large-scale files, avoiding issues such as lag or unexpected crashes—problems they previously encountered with other software. This high degree of stability allows Novisa to navigate complex designs effortlessly, making adjustments as needed without delays caused by system slowdowns

or interruptions.

"Creating detailed technical plans, analyzing estimates, and exporting to formats like DWG have all become simpler and faster with ZWCAD," Saiko highlights, "helping the team work effectively while maintaining the high standards they're known for in every project."



Novisa Modern, an exclusive residential project in Nowa Wola, featuring 59 semi-detached homes with modern architecture, cozy charm, and thoughtfully designed spaces

## Driving Cost Savings and Operational Growth

Transitioning to ZWCAD allowed Novisa to optimize expenses by reducing costs associated with previous CAD software. By reducing overhead, Novisa can allocate more resources to their projects, improving quality and enabling the company to expand its vision for sustainable housing.

With ZWCAD as an integral part of their process, Novisa is positioned to take on even more ambitious projects, confident in their ability to provide sustainable, high-quality residential spaces that meet the needs of the Polish market. Yuliia Saiko shares, "Our goal is to build homes that combine functionality, modern design, and proximity to nature. With tools like ZWCAD, we can more effectively accomplish this mission".

## ZWSOFT

ZWSOFT has been delivering reliable all-in-one CAX solutions since 1998. With over 20 years of experience, our products have been chosen and trusted by over 1.4 million customers in more than 90 countries worldwide.

32/F, Pearl River Tower, Guangzhou, China  
+86-20-38289780  
sales@zwsoft.com  
www.zwsoft.com