

Libra Techcon Limited



Libra Techcon is a professional company offering technology / know-how, engineering services related to Chemical Process Plants (with specialization in the field of Methanol and Ethanol downstream chemicals). We provide complete turnkey solutions starting from concept to commissioning & have set up various projects based on our Technology in past 30 years in India and abroad.

“We have been using CADISON® now for over 2 years. We have mainly benefitted in the area of piping. With AutoCAD earlier we had to first prepare piping plan then isometric and then take BOQ manually. Whereas with CADISON® we are able to standardize the catalogs and specifications, create 3D models and extract GA drawings, Isometrics & BOM there by not only save time but eliminate manual errors resulting in cost saving. We are now able to do more projects with same man power. CADISON® has improved the quality of drawings which have been appreciated by our customer and increased our credibility / capabilities.”

Milind Bhave
Director, Libra Techcon

Business Challenges:

Our Technical consultancy services division provides Design engineering services for key chemical projects in India and EMEA region. With the growing business, it was challenging for us to use primary drafting tool to produce high quality engineering construction packages. Most of the engineering was done at site with material wastage and delays in projects. We decided to standardize on a CAD platform which can help identify clashes, generate isometrics and accurate BOQs. After a thorough evaluation of various CAD softwares, our technical services team finally decided on CADISON® platform. One of the key advantage that was appreciated by our team is that “CADISON®” allows to standardize the Catalogs information of Equipments and Pipe specification for different Media which are required for a chemical process and helps re-use the database by modifying the capacity requirements.”

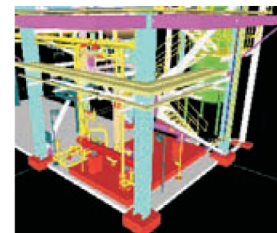

Modules Installed: Project-Engineer, 3D-Designer, P&ID-Designer, Electric-Designer & MATPIPE

Galaxy Surfactants



Galaxy Surfactants is a global leader supplying a wide range of innovative products to over 1000 customers in 99 countries. These include world's leading brands like Colgate, Unilever, Henkel, Reckit benckiser.

Our products include specialty chemicals like surfactants, mild surfactants, Rheology modifiers, perlizing agents, conditioning agents, blends based on innovative concepts, proteins for personal care.

“We see benefit mainly in the areas of piping, electrical & instrumentation using CADISON®. Features like automatic extraction of Isometrics, GA drawings, Hookups and various reports in a shorter timeframe will improve efficiency.”

Avinash Shinde
Leader, Projects

Business Challenges:

We are an Owner Operator having multiple plants across the globe and owns the process formulation of the plants which is patented and cannot be shared with any external firm.

We decided to setup an Engineering office with a need to maintain our Plant and equipments data of three locations in one Plant Engineering Solution. Main objective of the Engineering office was to support future expansion, technology upgradation and support Maintenance Repair Organization (MRO). One of our main requirements was an integrated software which can simultaneously address multi-disciplinary requirements viz. Mechanical, Piping E&I, Structural. After a thorough evaluation of various softwares and high end solutions, we chose CADISON® as our Plant Engineering Solution. We finalized on CADISON® software from ITandFactory GmbH (a 100% subsidiary of Neilsoft Ltd.) on the basis of excellent technical features, result oriented outputs, appropriate cost, fantastic customer feedback. After the initial training from Neilsoft team, we were able to create Intelligent P&ID diagrams, prepare 3D detailed layout of Equipments, Structures and Piping as well as extract MTO's and BOM in our full format templates. We believe CADISON® will deliver the results which we found during evaluation while implementing it on a large scale project.



Modules Installed: 3D-Designer, P&ID-Designer, Electric-Designer & MATPIPE